

# WILDLIFE WATER GUZZLER

## MATERIALS LIST:

7' x 4' roof made from 2 sheets 7' x 2' corrugated tin

(8) 2" x 4" x 8' studs

(1) 30 gallon barrel

4' length of guttering

1" PVC to connect gutter to barrel

(1) faucet

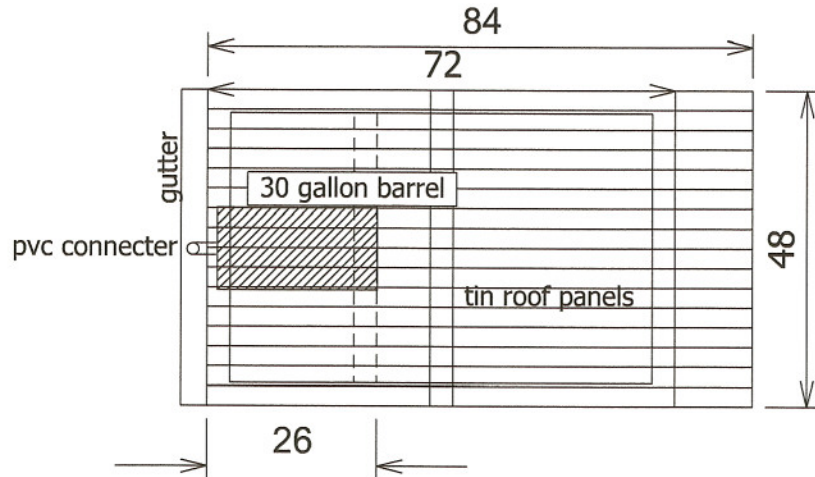

TOP VIEW

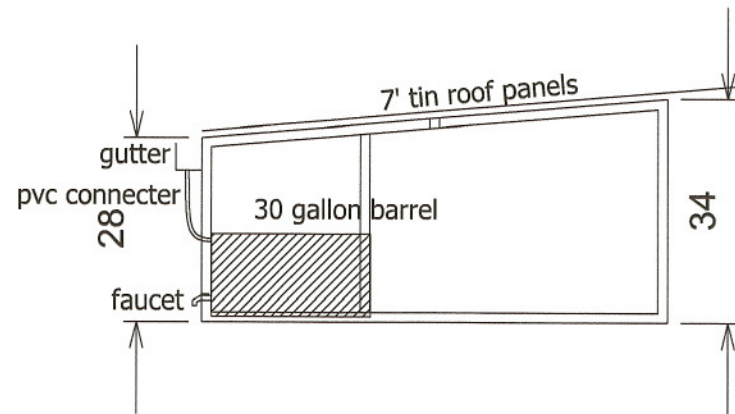

SIDE VIEW